

# SWING GATE - MANUAL

## Step 1: Setting Up the Post

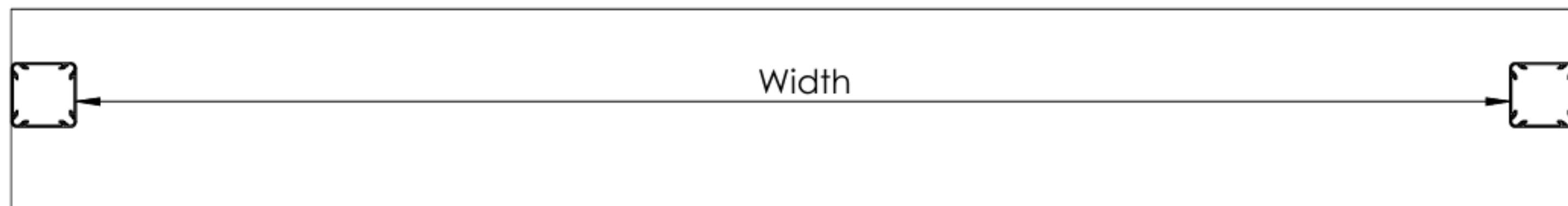

Place the 180x180 posts at the required opening width according to the design measurements. Ensure each post is perfectly plumb and level by checking both vertical and horizontal alignment using a spirit level or a laser level. Confirm that the posts are aligned straight and not twisted in any direction.

## Step 2: Fixing the Bottom Hinges

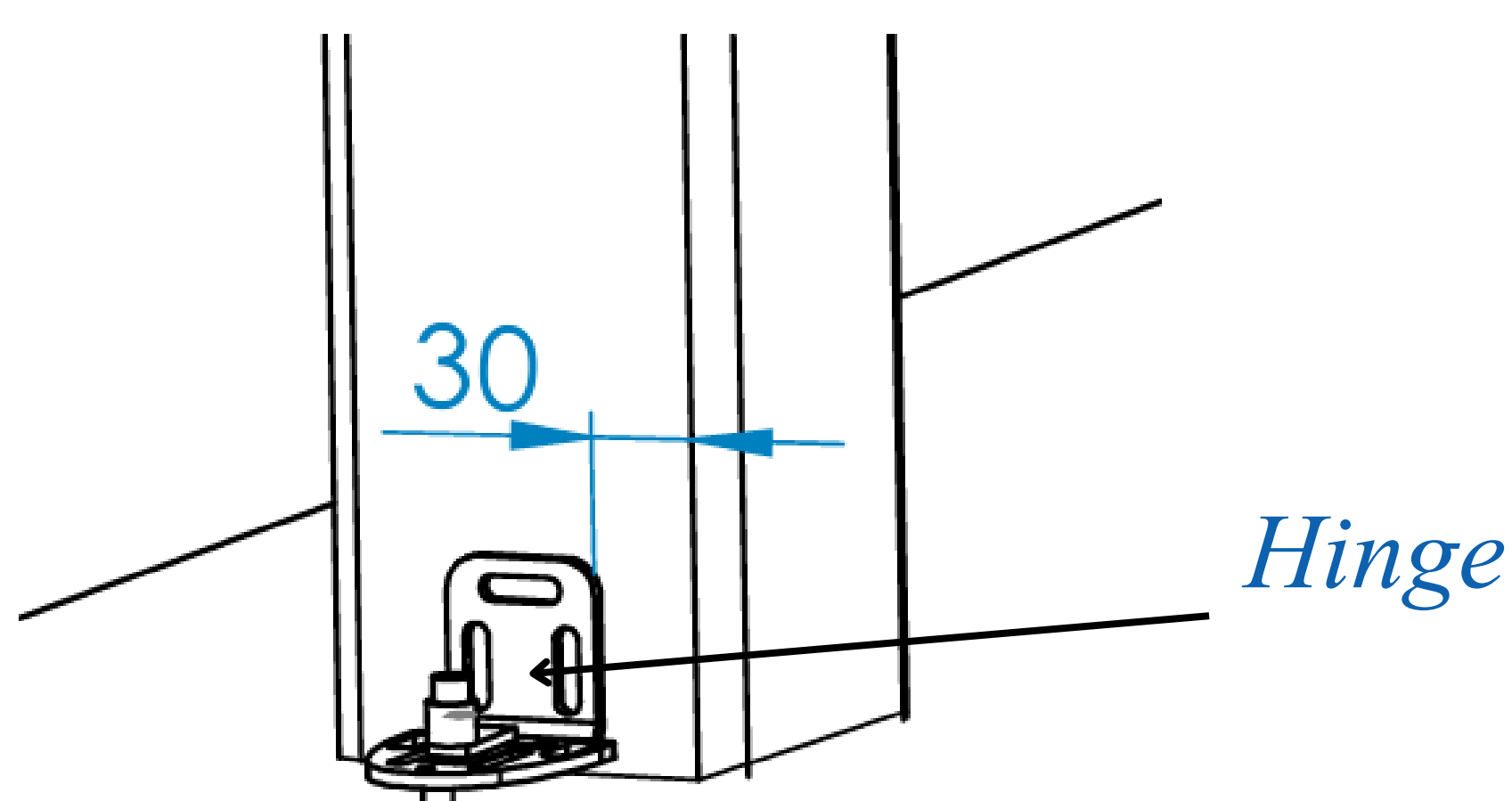

Place the hinges on the ground in the positions shown in the figure. Ensure that a minimum clearance gap of 30 mm is maintained between the hinge and the close side of the gate, as indicated in the figure. If the hinge is to be mounted directly onto the gate post, drill and tap for M8 bolt and use the M8 bolts provided in the kit. If the hinge is being mounted onto a wall surface instead, use M8 coach screw with wall plugs for secure fixing. Similarly, position the bottom hinge on the opposite side, ensuring proper alignment. Do not fully tighten the hinges at this stage—just mark the positions and temporarily secure them for alignment checks.

### Step 3: Fixing the Top Hinges



Similarly, position the top hinge in alignment with the bottom hinge as shown in the figure. Ensure that the bottom face of the top hinge is placed at the height specified in the figure. Verify that both hinges are aligned vertically and level with each other to ensure smooth and stable gate movement. Once the alignment is confirmed, accurately mark the fixing points. Permanently fix the bottom hinge first, but do not fix the top hinge at this stage.

### Step 4: Hanging of the Leaf

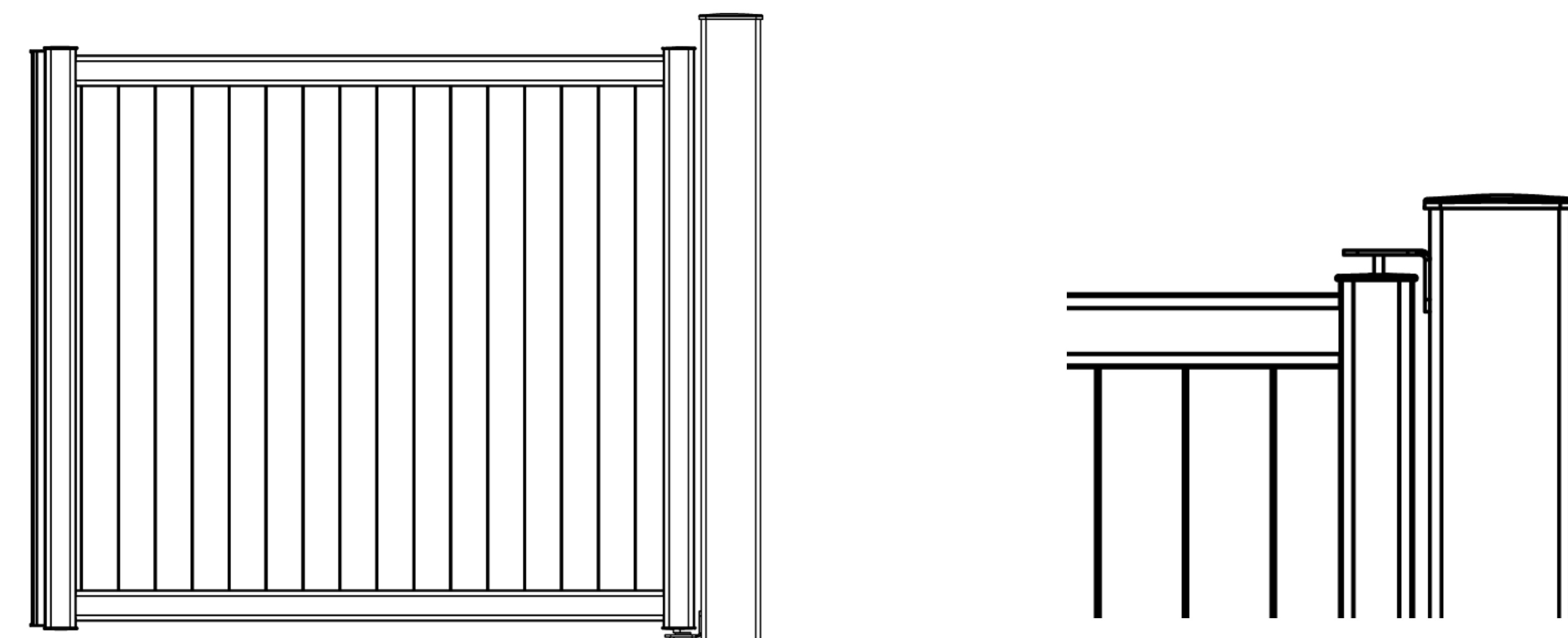

Carefully lift the gate leaf and place it onto the hinge pin of the bottom hinge, ensuring that the hinge bush is correctly positioned on the hinge pin before lowering the leaf. Once the leaf is seated properly, position the top hinge around the hinge pin. Check the gate leaf for proper plumb and alignment on both the Swing Side and the Close Side. After confirming correct alignment and smooth operation, permanently fix the top hinge in place. Finally, open the gate fully to confirm that the hinges are operating freely and securely.

Repeat the same procedure for the other gate leaf, ensuring proper installation and alignment of both the top and bottom hinges in the same manner.

## Step 5: Checking the Plumb and Level

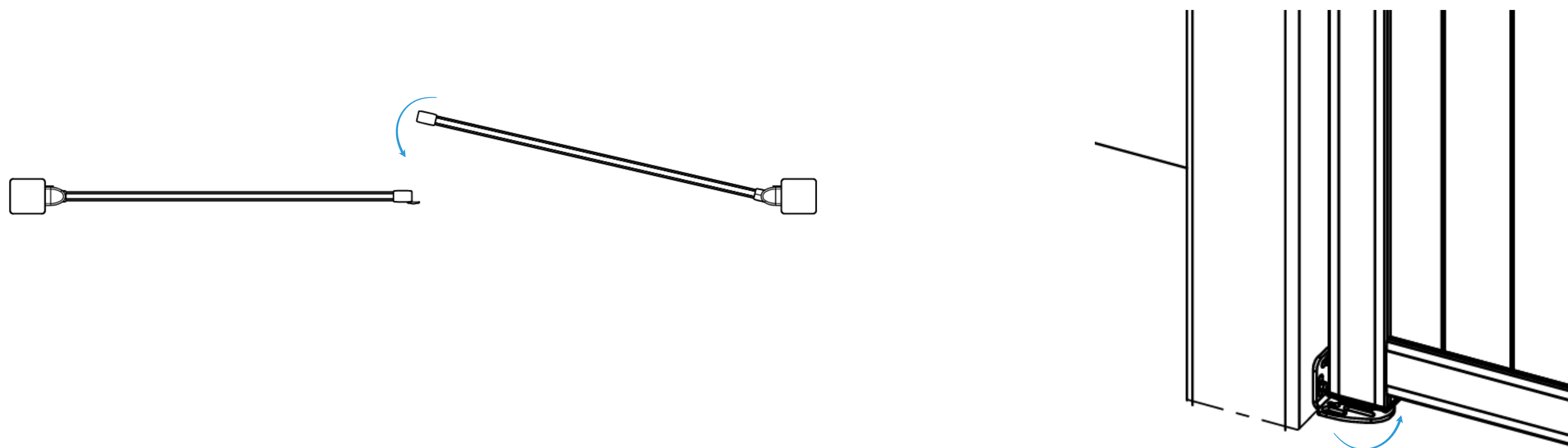

Fully close the gate leaf that includes the overlapping closing profile first. Then, close the second leaf and check the alignment between both gate leaves to ensure they match correctly along the closing edge. If any misalignment is observed, adjust the hinge pins of the top and bottom hinges as necessary to achieve proper positioning and smooth closing.

## Step 6: Fixing the Stopper

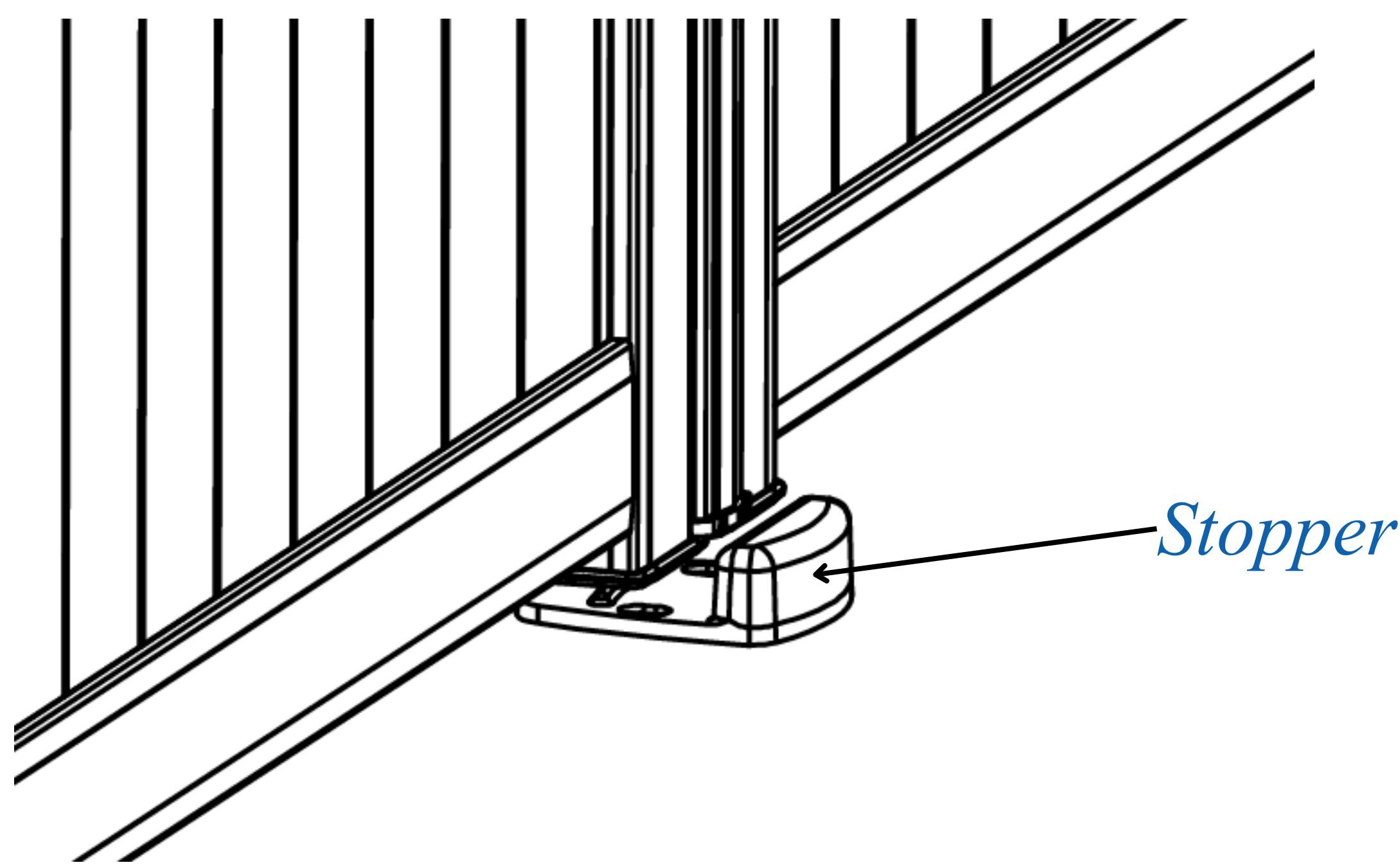

After closing the gate completely at the correct level, position the stopper as shown in the figure. Ensure that the stopper is properly aligned with both gate leaves. Mark the hole positions accurately and secure the stopper using screws and plugs suitable for the mounting surface.



## Step 7: Fixing the Top Hinge Cover

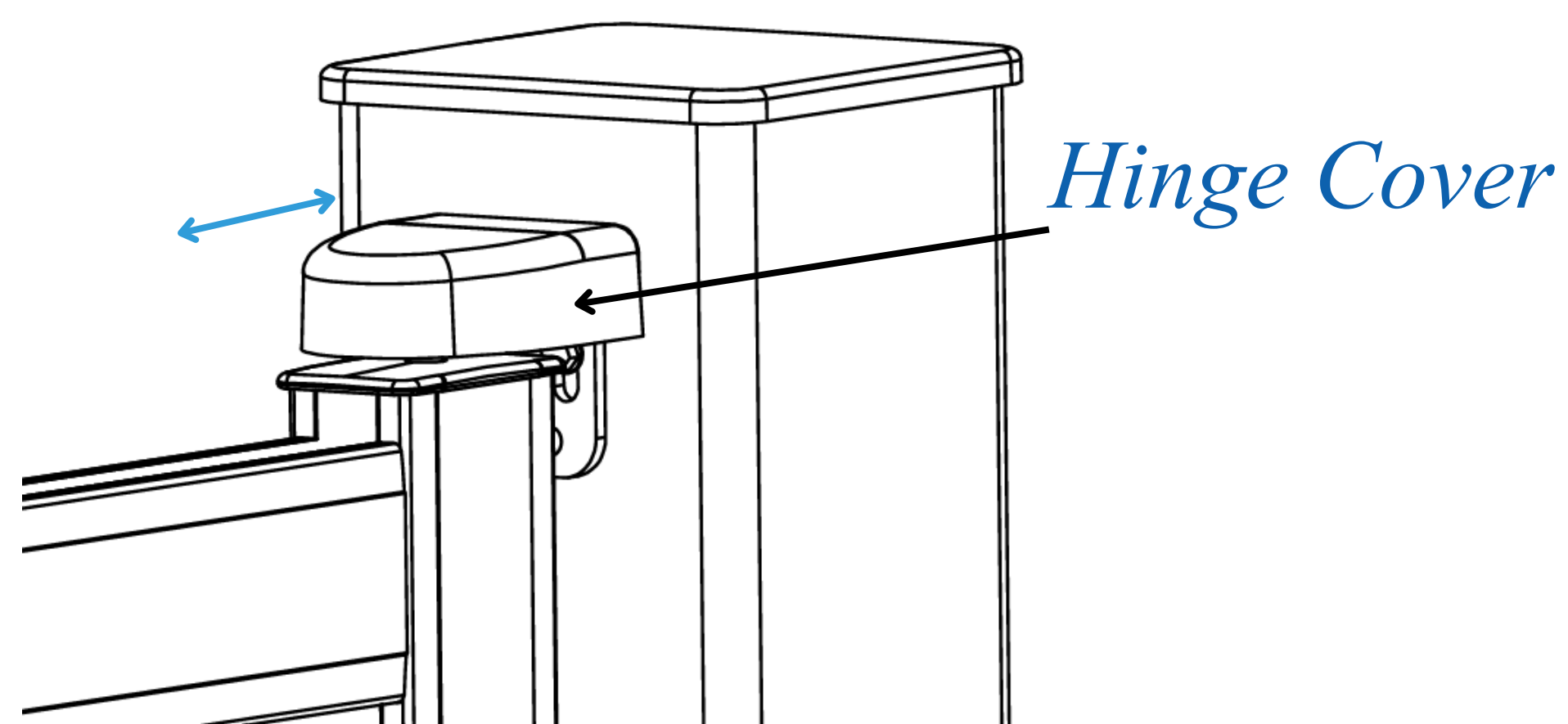

Slide the hinge cover into position and lock it securely in place. Repeat the same procedure for the hinge cover on the opposite side.

## Step 8: Fixing the 50x30 Profile Gap Filler

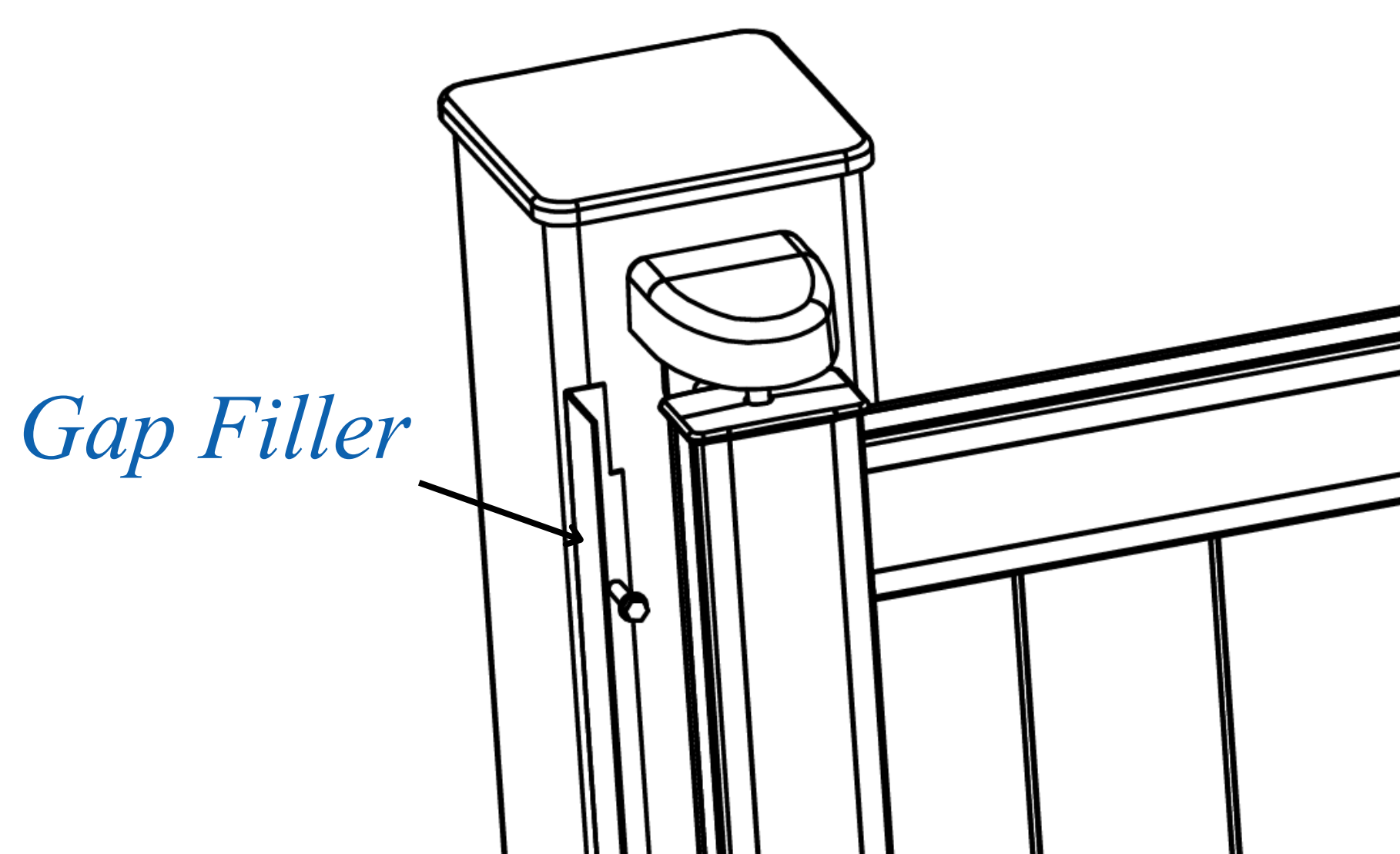

Fully open the gate and position the 50×30 mm profile as shown in the figure. Ensure that the 30 mm notched side of the profile is aligned flush with the post or pillar as illustrated. After placing the profile, gently open and close the gate to confirm that there is no obstruction during movement. Adjust the profile position as required so that it does not interfere with the gate operation and is mounted at the correct height. Once the placement is verified, securely fix the profile using No. 8 self-drilling panel head screws for post mounting, and No. 8 self-tapping panel head screws with wall plugs for wall mounting.